

REPLACEMENT PROCEDURE FOR PISTON CUPS

1.

Start the truck engine, engage the PTO and turn the remote on. Close the ball valve on the driver-side hydraulic ram near the front of the cylinders. To do this: release the bolt on the top of the valve, remove the handle and the locking disc, reinstall the handle and turn it 90 degrees (closed). (See figure 1)

FIGURE 1

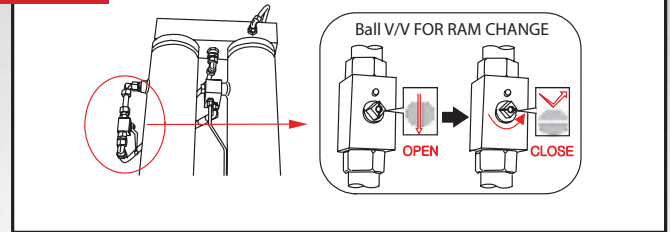

2.

Engage the pump with the remote and complete three strokes (ensure the pump volume and rpm are low). After doing this, close the ram change ball valve located in one of two locations as shown. (See figure 2)

The passenger-side cylinder will come all the way to the top and not change over. At this time the hydraulic system will load up (high pressure); push the pump on/off switch to stop this. Turn the PTO off. Turn the truck off and drain the hydraulic tank air pressure before the next step.

FIGURE 2

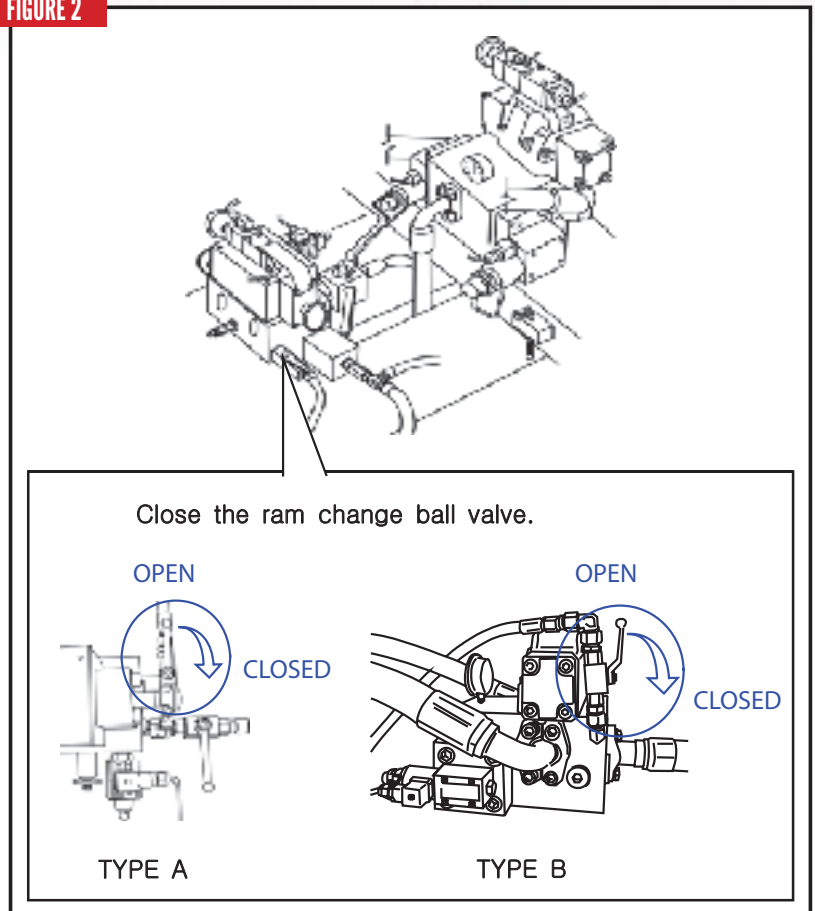

3.

Remove the four M16 bolts from the spacer flange. Using the provided 60mm wrench on the spacer flange will help to remove the hardware. Once the hardware is removed, discard the bolts and lock washers. Slide the piston cup down the barrel about 1/2" to allow removal of the spacer flange. Once the spacer flange is removed you will be able to pry the piston cup out into the water box; rotate the piston 90 degrees to remove it from the water box. (See figure 3)

FIGURE 3

